

Resource
Data Management

Mercury Remote Display

Installation/User Guide
Revision 1.0



PR0725

Contents

Mercury 2 Remote Displays – PR0725	3
Mercury 2 Remote Display	3
Mounting	4



Please ensure all power is switched off before installing or maintaining this product.

Mercury 2 Remote Displays – PR0725

Mercury 2 Remote Display

Mercury 2 Remote Display



Mercury 2 Panel Cut out

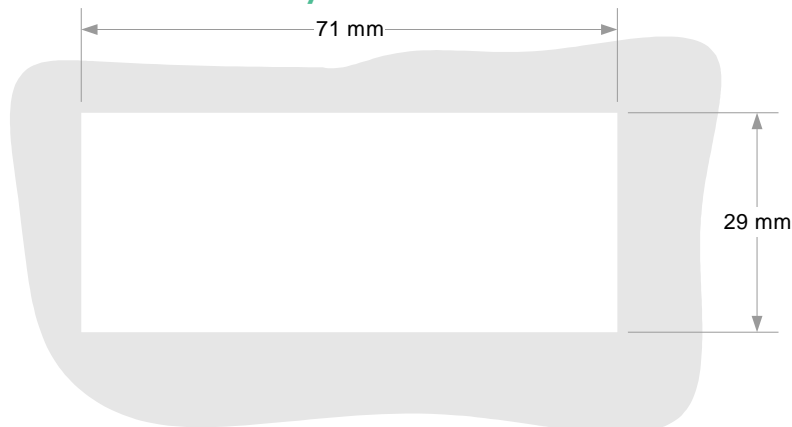

The Mercury 2 fascia is 78mm x 36mm and is central around the cut-out.

The Mercury 2 fascia depth is 31mm. An additional 15mm at the rear is required for cable clearance

Note: this is a generic display. For specific functions please refer to the appropriate controller document.

To ensure the correct operation of the Mercury MK2 Remote Display, when connected to a Mercury MK1 or Powertray controller only, then the controller software must be version V10.1 or higher.

Display comes complete with 5m cable.



Please ensure all power is switched off before installing or maintaining this product.

Mounting

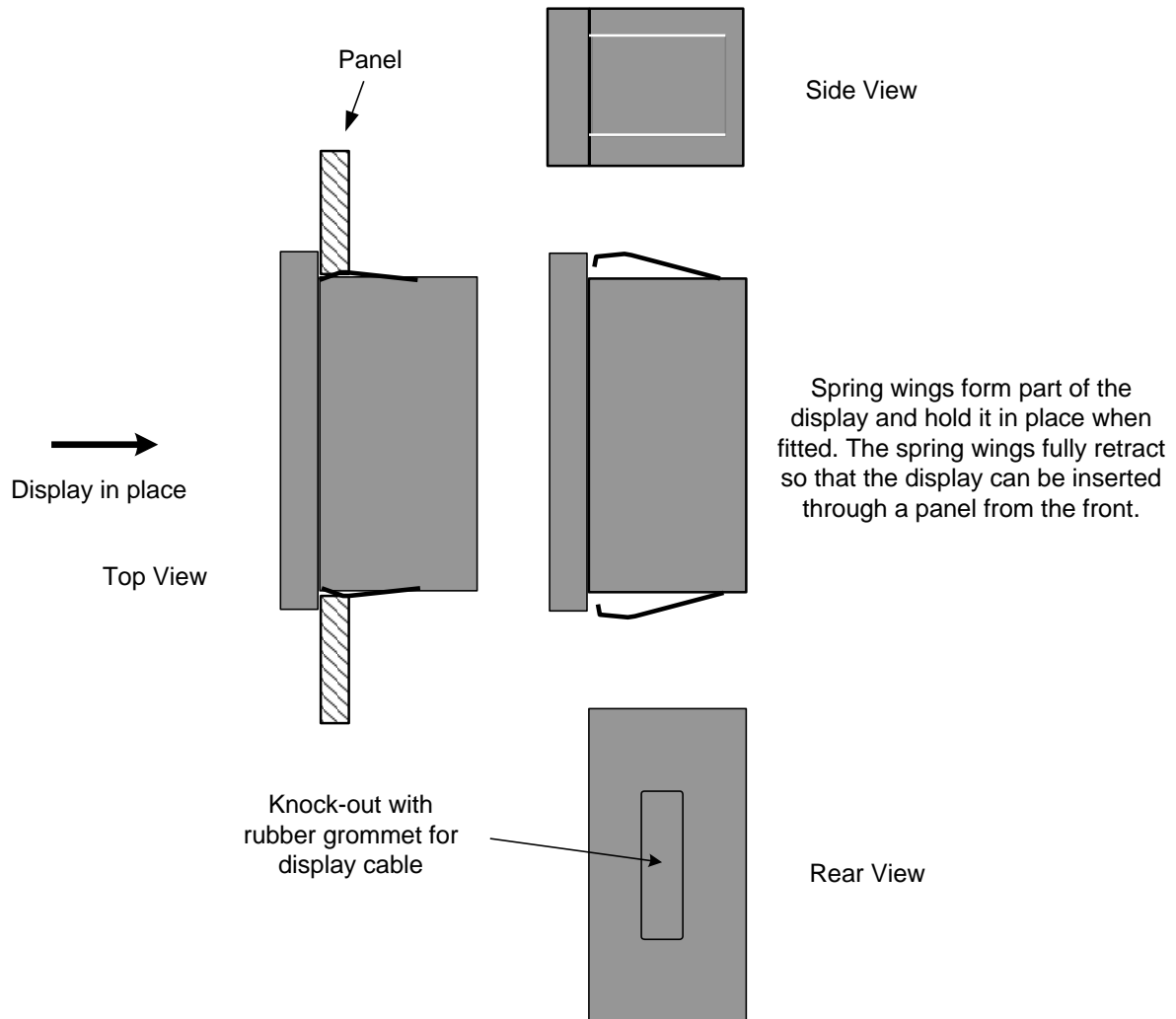

Please ensure all power is switched off before installing or maintaining this product.

Group Offices

RDM Group Head Office

80 Johnstone Avenue
Hillington Industrial Estate
Glasgow
G52 4NZ
United Kingdom

+44 (0)141 810 2828
support@resourcedm.com

RDM USA

9441 Science Center Drive
New Hope
Minneapolis
MN 55403
United States

+1 612 354 3923
usasupport@resourcedm.com

RDM Asia

Sky Park at One City
Jalan USJ 25/1
47650 Subang Jaya
Selangor
Malaysia

+60 3 5022 3188
asiatech@resourcedm.com



Visit www.resourcedm.com/support for more information on RDM solutions, additional product documentation and software downloads.

While every effort is made to ensure the information given within this document is accurate, Resource Data Management Ltd shall not be liable for errors or omissions, for incidental or consequential damages, directly or indirectly, in connection with the furnishing, performance or misuse of this product or document. All specifications are subject to change without notice.

See www.resourcedm.com for terms and conditions of sales.

Copyright © Resource Data Management